

Bersagli 14x14 da stampare su carta o cartoncino A4 e da ritagliare per adattare ai portabersagli.

Ritagliare solo lungo i margini tratteggiati.

La parte in eccesso va lasciata, e piegata per aumentare la rigidità della carta.

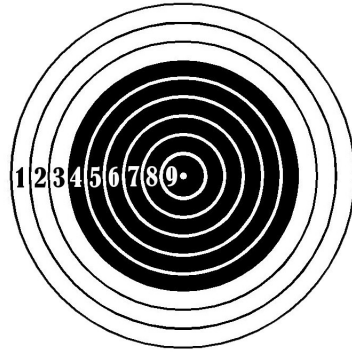
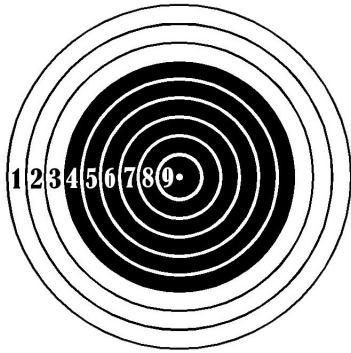
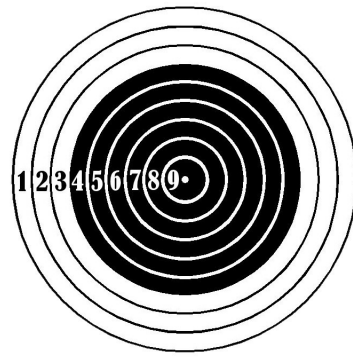
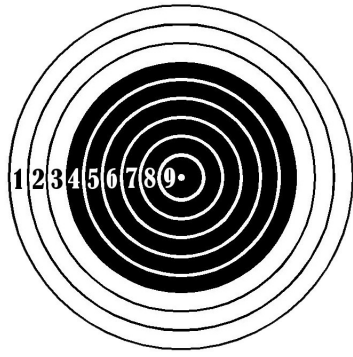
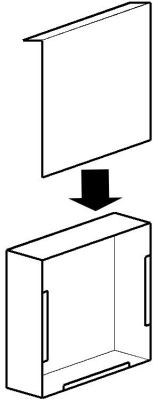

<http://www.airgunz.altervista.org>

<http://www.airgunz.altervista.org>

